

Plug-in Sensor

With connectors on the standard floodlight, the sensor can be plugged into the fixture very easily, to realize Micro-wave or PIR sensor function. The female and male connectors are specially made to get waterproof IP65.

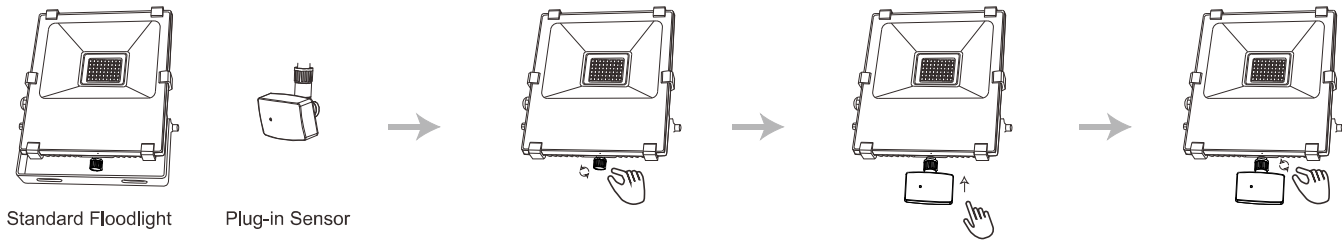

With sufficient light, the lamp doesn't switch on.



With insufficient ambient light, the sensor switches on the lamp when motion is detected.



After hold time, the sensor switches off the lamp when no motion is detected.

Micro-wave

Power Sourcing: 220V/AC-240V/AC	Detection Range: 180°
Power Frequency: 50Hz	Detection Distance: 2-12m (radius) adjustable
Ambient Light: 3-2000LUX (Adjustable)	HF System: 5.8GHz CW radar, ISM band
Time-Delay: Min.:10sec±3sec Max.:15min±2min	Transmission Power: <10mW
Power Consumption: 0.9W	Installing Height: 1.5m~3.5m
Rated Load: 300Wmax	Detection Motion Speed: 0.6~1.5m/s

Setting

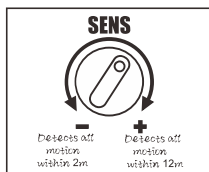

SENS Adjustment

SENS Knob controls the sensitivity, the detection area
Turn the sensor SENS knob counter-clockwise to decrease the sensitivity to lowest level=within 2m, and to the highest level=within 12meters

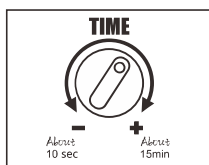

TIME Adjustment

LUX knob determines how long the floodlight will stay on after the last motion has been detected
Turn the sensor TIME knob counter-clockwise to decrease the time to 10 sec.
Turn the sensor TIME knob counter-clockwise to increase the time to 15 min.



LUX Adjustment

LUX knob determines at what light level the floodlight will start working. It is actually controlled by built-in light sensor
Turn the sensor LUX knob counter-clockwise to the moon(dusk) setting. In this provisional setting model, the sensor remains inactive during daylight. At dusk when you find it is the desired night level to start work, then simply set it to the position it needs to become operative as daylight declines

